

## RADIO CONTROL SOLAR ALARM POWER CLOCK

Cat. No. 39 627

### Instruction Manual

#### Technique Parameter:

1. Battery: 1XAA 700MAH rechargeable batteries

2. Energy Consumption:

ALARM CURRENT <12MA,

RECEIVING CURRENT <105UA,

CURRENT CONSUMPTION NORMAL <25UA,

LIGHT<100MA

Using time: around 20 months when power is full if energy consumption <1.09MAH

#### Using Instructions:

1. Put battery into compartment, the clock will receive signal when the hour and minute hands move to 4:00/8:00/12:00 automatically.
2. If after ten minutes no signal is received then the radio control signal is not strong enough or unavailable and the clock will need to be set manually.

#### How to Set Time Manually:

- 2-1. Press "M.set" longer than 3 seconds to start the time setting function time starts and keep it pressed until the hour and minute hands move to the desired time.
- 2-2. To ensure that the clock is set to the exact time desired, please keep the "keypress" status for some time until the hour and minute hands move close to your desired time but not exact time then stop and then begin to press "M. Set" button immediately and then stop and then begin to press again and then stop....; repeat until the hour and minute hands move to the exact time desired. Combined with process 2-1 will make the time setting quicker.
- 2-3. Exit the manual setting status: Press "M.set" long for 8 seconds.
3. Clock is working when receiving signal

#### How to Set to Receive the Signal:

- 4-1. When a signal can be received it is updated 8 times everyday. The receiving times are AM2:00; AM3:00; AM4:00; AM5:00; PM2:00; PM3:00; PM4:00; PM5:00.
- 4-2. REC button: press it long for 3 second to set the function of receiving signal manually.

#### How to Set Alarm:

- 5-1. "ON" and "OFF" buttons: are only related to alarm setting. To set alarm function, it must be on "ON" status.
- 5-2 .Set alarm: Set to desired time in counter-clockwise direction

**Snooze and light Functions:**

6-1. Snooze and light button: press it, light is on.

6-2. To stop alarm, please press Snooze and light button again (when the alarm is on) and reactive itself in 5 minutes. To close the alarm function, push “ON” button to “ OFF” button.

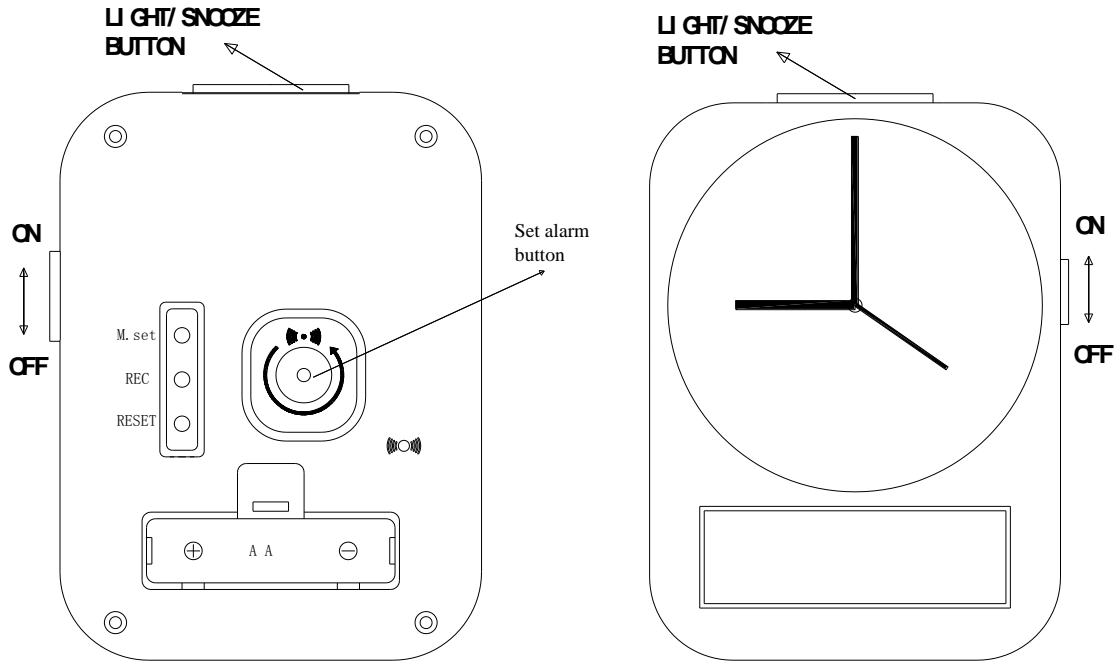

**Remarks:**

1. Press “RESET” or check the battery if clock doesn’t work.
2. Please take out battery if not using for a long time.
3. Do not use normal battery
4. In order to charge battery, the solar panel must be have light
5. Please check and charge battery if clock doesn’t work well.

**DISPOSAL:**

The packaging material is reusable. Dispose of the packaging in an environmentally friendly way by putting it in the appropriate recyclable waste collection containers.



Dispose of the product and the batteries in view of the environment if you want to separate. The device and the batteries must not be thrown in with domestic waste. Take them to a recycling center for used electrical and electronic devices. For more information you can consult your local government. Remove batteries first.

Eurotops Versand GmbH  
Elisabeth-Selbert-Straße 3  
40764 Langenfeld, Germany



If technical support is needed, please call ...

in Germany 0180 . 530 63 63\* or [info@eurotops.de](mailto:info@eurotops.de)

in Austria 01 . 230 60 43 12 or [info@eurotops.at](mailto:info@eurotops.at)

in Switzerland 044 . 28 36 125 or [info@eurotops.ch](mailto:info@eurotops.ch)

in the Netherlands 026 . 37 36 333 or [info@eurotops.nl](mailto:info@eurotops.nl)

in France 0892 . 700 470\*\* or [info@eurotops.fr](mailto:info@eurotops.fr)

\* 14 Cents/minute via German landline, max. 42 cents/minute via mobile phone network

\*\*34 Cents/minute via French landline

A possible return of products should be addressed to the return address stated on your invoice.

The manual only reflects the technical conditions available under printing. Any changes in technology and equipment are reserved.

© 12.09.2012